

TIM-00X

Token Issuing Module

Feature

- High speed token processing
- Intelligent transport unit detection
- Token magazine design with high security
- Friendly maintenance and high reliability

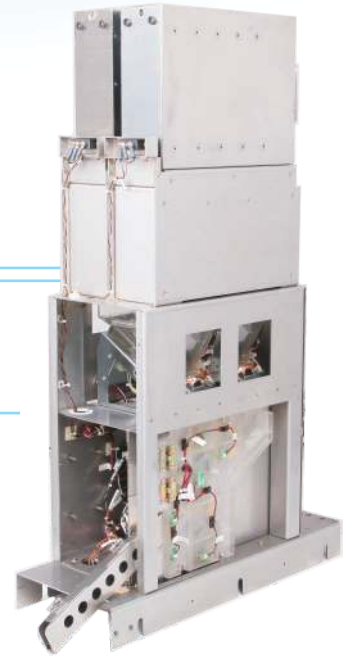

TIM-00X bears a design concept of high security and reliability. The 2 token magazines function as the backup for each other to meet the application demand under large passenger flow volume. It features high processing speed of tokens of multiple sizes and invalid token rejection. Intelligent detection of transport unit ensures fast trouble location. Secure lock and iButton provide realtime safeguard to token magazine. TIM-00X will definitely be the choice you never regret.



Metro



City Coach



BRT

TIM-00X

Token Issuing Module

Performance

High Security and Reliability

- Adapt to tokens of multiple sizes
- Double token detection increases data accuracy
- Fast token clearance in one time
- Intelligent token magazine status detection
- Electric tag (ibutton) supports token magazine tracking during operation
- Stainless steel token magazine with double locks ensure high security of token inside
- Invalid token rejection reduces transaction disputes

High Efficiency

- Token issuing speed <math>< 2\text{s}/\text{token}</math>, meet the demand of fast transaction
- 2 token magazines with a large capacity of 1000tokens decrease replenishment frequency and operation cost

Friendly Maintenance

- Long service life and no consumable parts
- Token loading box and token vault are compatible to reduce operation cost
- Multiple sensor and transparent transport unit ensure fast token jam location
- Transport unit can be opened with bare hand ensures fast token jam solution

Dimension(Unit: mm)

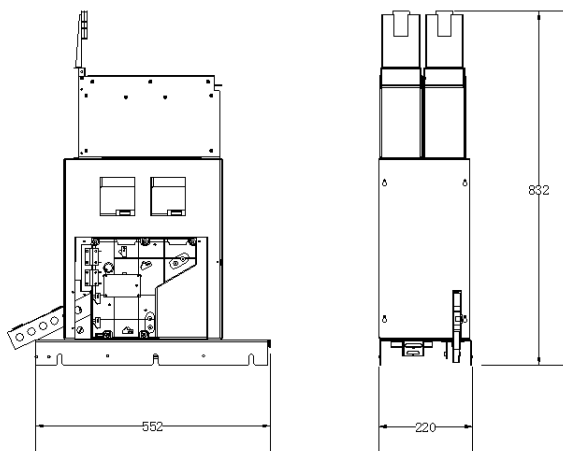

Specification

Speed

- Issuing $\leq 2\text{s}/\text{token}$ (0.5s for token reading)
- Clearance $\leq 0.6\text{s}/\text{token}$

Token Dimension

- Diameter: $30 \pm 1\text{mm}$
- Thickness: $2.1 \pm 0.2\text{mm}$ (or $3 \pm 0.2\text{mm}$)

Capacity

- Magazine: 1000-1500tokens $\times 2$
- Loading box: 1000tokens $\times 2$
- Rejection bin: 300tokens

Power

- DC $24\text{V} \pm 10\%$, 30W(max)

Communication Interface

- RS-232

Weight

- 27kg

Environment

- Working temperature: $-5^{\circ}\text{C} \sim 50^{\circ}\text{C}$
- Working humidity: 20%~90%RH
(non condensing)

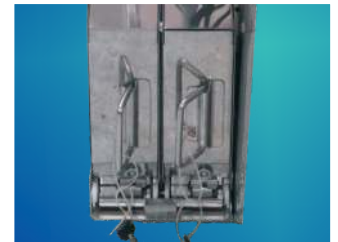

High reliability



Fast token jam solution

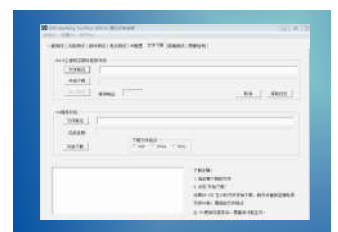

Online upgrading

Note: In case the specifications be upgraded, you may as well contact with us to get the latest information.

GRGBanking Equipment Co., Ltd.

Add: 9 Kelin Road, Science City, Luogang District, Guangzhou, China 510663
 Tel: +86 20 6287 9763
 Fax: +86 20 6287 9976
 Email: oem@grgbanking.com

Copyright by GRGBanking Equipment Co., Ltd.
 All rights reserved@201605

Specifications are subject to update without prior notice.
 Please consult GRGBanking or its representative for the latest information.

www.GRGBanking.com